



THE MULIA, MULIA RESORT & VILLAS
NUSA DUA - BALI



Where Love Meets Legend

Bali's most iconic wedding destination, offering world-class venues, exquisite dining, and three luxury resorts within one breathtaking setting.

Dream Weddings



Why Mulia Bali for Weddings?

A world where love is celebrated in its most exquisite form.

1. Scale & Choice

- **10+ venues:** Two pillarless ballrooms (up to 2,000 guests), beachfront gardens, the iconic Eternity Glass Chapel, and intimate event spaces for smaller celebrations.
- **Three resort experiences:** The Mulia (all-suite beachfront), Mulia Resort (luxury lifestyle), and Mulia Villas (private pool villas) for bridal parties, family, and guests.
- **Integrated resort concept:** Ceremony, reception, accommodation, and honeymoon—all within one destination.

2. Culinary Excellence

- **Award-winning four signature restaurants**, spanning Japanese, Chinese, Mediterranean, and international cuisines.
- Fully **customisable banquet menus**, from plated fine dining to buffets and themed food stations.
- Renowned as **Bali's luxury dining destination**, ensuring culinary experiences impress even the most discerning guests.

3. Seamless Planning & Service

- **Dedicated on-site wedding specialists** and a network of preferred external planners.
- **Tailored wedding packages.**
- A dedicated night club that is perfect for after-party.



Venues

Virtual Tour of Facilities - https://geckodigital.co/vt/TheMulia/?ss=scene_Aerial_Overview&noUI&whs



Bali's First Multi-Resort Integrated Wedding Destination

Three resorts. One iconic setting for your celebration of a lifetime.

- **Mulia Resort:** A vibrant beachfront haven with grand event spaces, multiple dining venues, and endless lifestyle experiences—perfect for hosting lavish receptions, cultural ceremonies, and multi-day wedding celebrations with family and friends. Mulia Resort's diverse accommodation options, from garden to ocean-view rooms and suites, including adjoining rooms and twin-bed layouts, are ideal for welcoming wedding guests in comfort and style.
- **The Mulia:** An enclave of all-suite beachfront elegance with sweeping sunrise views and personalised butler service—designed for couples seeking refined intimacy and VIP guests who expect exceptional comfort. For those desiring the utmost exclusivity, a private resort buyout offers an ultra-private wedding experience.
- **Mulia Villas:** Bali's largest private pool villas provide the pinnacle of seclusion and luxury—ideal for families or wedding parties who value space, privacy, and personalised butler service, creating the perfect sanctuary for pre- or post-wedding retreats.



Venue & Capacities

Lobby Level

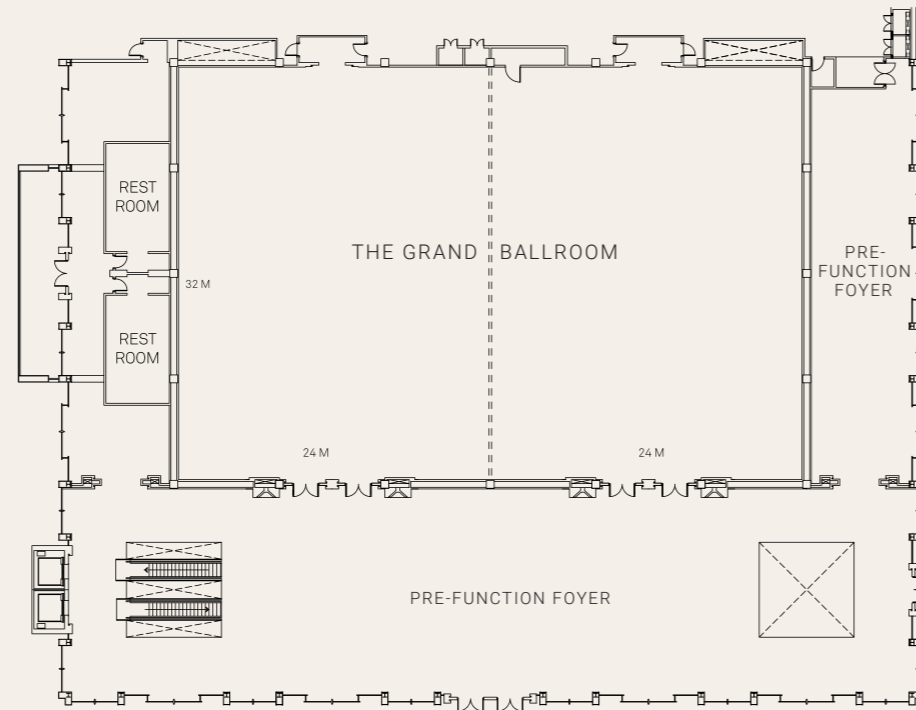

Promenade Level

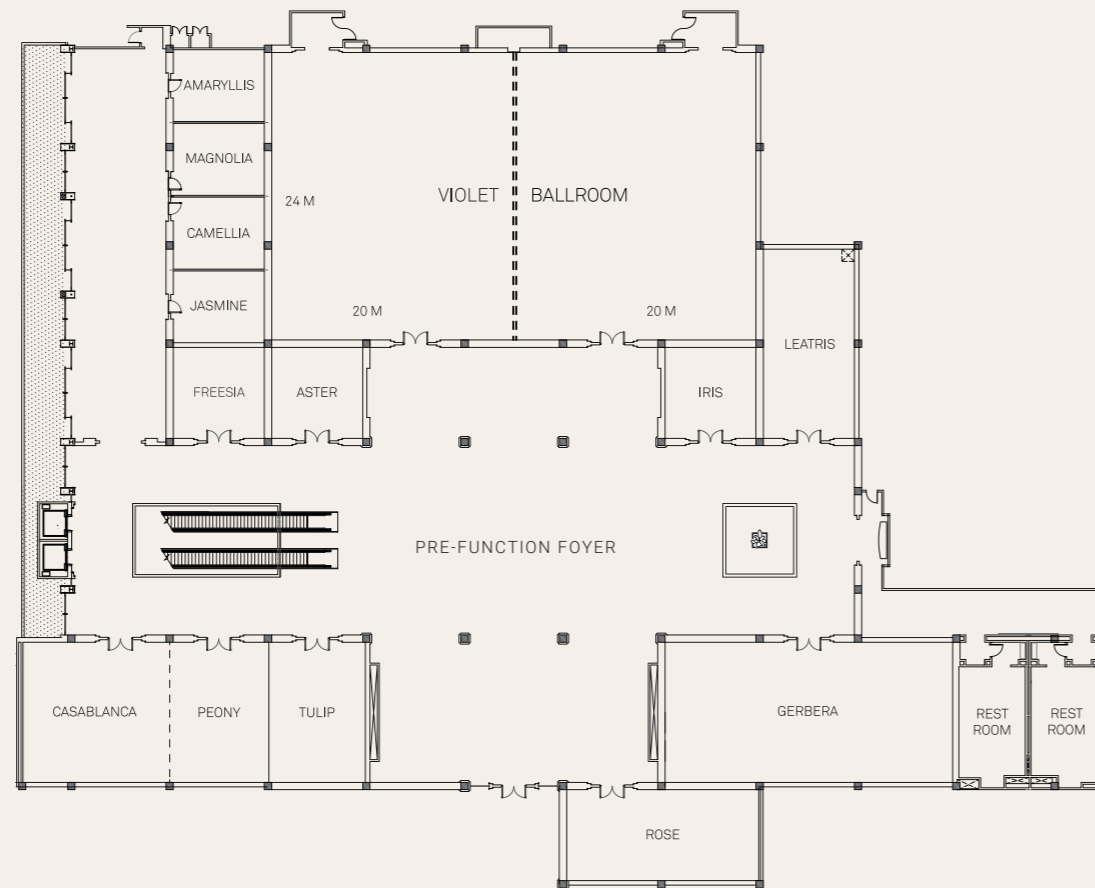

Function Rooms	Size (m)			Size (ft)			Capacity					
	W x D	SQM	H	W x D	SQF	H	Theatre	Classroom	U-Shape	Round Table	Cocktails	Boardroom
Lobby Level												
The Grand Ballroom	48 x 32	1,536	6.5	157.4 x 105	16,526	21	2,055	1,140	-	1,080	2,000	-
Ballroom 1	24 x 32	768	6.5	78.7 x 105	8,263	21	1,000	513	-	540	1,000	-
Ballroom 2	24 x 32	768	6.5	78.7 x 105	8,263	21	1,000	513	-	540	1,000	-
Pre-function Foyer	64 x 16	1,177	4.5	209.9 x 52.5	11,020	15	-	-	-	-	1,500	-
Promenade Level												
Violet Ballroom	40 x 24	940	5	131.2 x 78.8	10,338	16	1,200	720	-	600	1,400	-
Violet Ballroom 1	20 x 24	470	5	65.6 x 78.8	5,169	16	600	360	-	300	700	-
Violet Ballroom 2	20 x 24	470	5	65.6 x 78.8	5,169	16	600	360	-	300	700	-
Casablanca	11 x 11	121	4	36.1 x 36.1	1,303	13	180	96	30	90	135	-
Peony	8 x 11	88	4	26.2 x 36.1	946	13	96	42	27	60	90	-
Casablanca & Peony (Combined)	19 x 11	209	4	62.3 x 36.1	2,249	13	276	138	50	150	230	-
Tulip	8 x 11	88	4	26.2 x 36.1	946	13	96	42	27	60	90	-
Rose	15 x 7	105	4	49.2 x 23	1,132	13	120	54	39	80	120	-
Gerbera	23 x 11	253	4	75.4 x 36.1	2,722	13	350	168	66	180	270	-
Leatris	7 x 15	105	4	23 x 49.2	1,132	13	130	54	39	80	120	-
Iris	7 x 7	49	4	23 x 23	529	13	60	24	18	40	60	-
Aster	7 x 7	49	4	23 x 23	529	13	60	24	18	40	60	-
Freesia	7 x 7	49	4	23 x 23	529	13	60	24	18	40	60	-
Jasmine	7 x 6	42	4	23 x 19.7	453	13	48	24	15	30	45	18
Camellia	7 x 6	42	4	23 x 19.7	453	13	48	24	15	30	45	18
Magnolia	7 x 6	42	4	23 x 19.7	453	13	48	24	15	30	45	18
Amaryllis	7 x 6	42	4	23 x 19.7	453	13	48	24	15	30	45	18
Outdoor Venues												
Unity Garden	-	2,000	-	-	21,527	-	-	-	-	600	1,000	-
Eden Garden	-	448	-	-	4,822	-	-	-	-	250	400	-
Mulia Glass House	12 x 20	240	6	39 x 65	2,559	19	200	140	50	120	200	48

*Capacities are approximate and may vary depending on final setup, décor, and safety requirements.

Wedding Venues

Grand Ballroom

An opulent ballroom for gala events, conferences, and grand celebrations.



Wedding Venues

Violet Ballroom

A refined and versatile venue, ideal for large-scale conferences, elegant receptions, and corporate meetings.



Wedding Venues

Mulia Glass House

Bali's newest beachfront venue with indoor elegance and ocean views.



Wedding Venues

Unity Garden

A 2,000 sqm beachfront venue with panoramic ocean and temple views.



Wedding Venues

Eden Garden

An enchanting garden setting for elegant outdoor receptions and banquets.



Wedding Venues
Eternity



Wedding Venues
Harmony



Mulia Resort Overview



Mulia Resort – Grandeur, Grandeur Deluxe & Mulia Signature

Elegant comfort with garden, courtyard or lagoon pool views.



Mulia Resort – Royal Suite

Spacious suite with sofa bed and versatile family-friendly layout.



Mulia Resort – The Duke Suite

Ocean-view suite with private butler and exclusive privileges.



The Mulia Overview



The Mulia – Baron Suite

Jacuzzi terrace with panoramic garden, ocean or lagoon views.



The Mulia – Earl Suite

Separate living and dining with sweeping ocean or garden views.



The Mulia - Marquess Suite

Two-bedroom suite with panoramic ocean views and refined privacy.



Mulia Villas Overview



Mulia Villas - One Bedroom Villa

Secluded villa with private pool and open-air living.



Mulia Villas - Family Villa

Two-bedroom villa ideal for families with lush garden views.



Mulia Villas - Marquess Villa

Expansive two-bedroom villa with sweeping ocean panoramas.



Signature Culinary Experience

- Tailored banquet menus (Western, Asian, Indian, Balinese).
- Live cooking stations and private chef options.



Cannelé Pâtisserie

Signature desserts and artisanal wedding cakes.



Dining Destinations - The Cafe

Eclectic fusion of global culinary traditions, offering an ethnic-gastronomic journey that showcases authentic dishes from around the world.



Dining Destinations - Soleil

Sanctuary for epicureans, renowned for its sumptuous Sunday Brunch.



Dining Destinations - Table8

The best Chinese and Cantonese dim sum experience in Bali.



Dining Destinations - Edogin

A refined and elegant setting where the art of Japanese cuisine is celebrated with a contemporary touch.



Dining Destinations - ZJ's Bar & Lounge

An intimate nightclub atmosphere and serene lakeside outdoor area with contemporary seating.



Dining Destinations

Showcase live kitchens, gala dining options, Sunday brunch, and incentive-friendly venues



Wedding Enhancements & Experiences

Include high-value touches that impress couples/planners:

- Exclusive honeymoon stays in Mulia Villas.
- Cultural entertainment (Balinese dancers, fireworks, live music).



Wedding Enhancements & Experiences

Photography-ready locations across the resort.

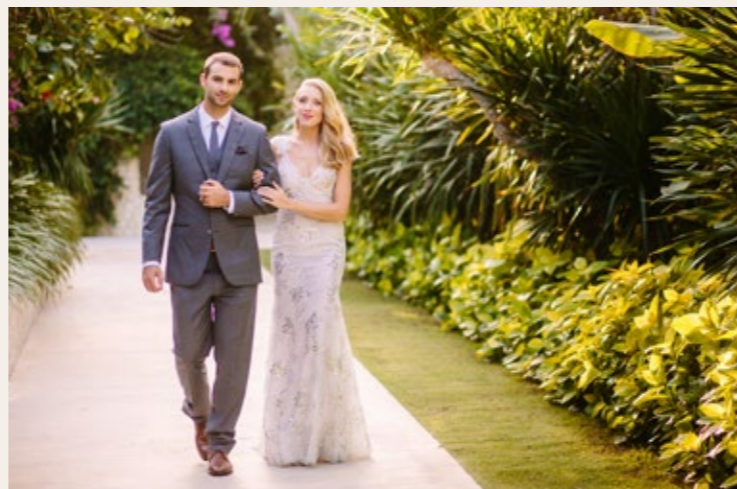

A World of Accolades



Your love deserves the grandeur of Mulia Bali.

Request for proposal www.themulia.com/bali/weddings/wedding-rfp



call +62 361 301 7777 or email wedding@themulia.com

Jl. Raya Nusa Dua Selatan, Kawasan Sawangan, Nusa Dua 80362, Bali, Indonesia

www.themulia.com/bali/weddings



TheMuliaBali